

# System Galaxy Screening Enforcement

- Control direction of cardholders between areas
- Prevent access until procedures have been followed
- Multiple areas within the same cluster/loop
- Easily adapted for differing applications
- 'Nesting' of areas
- Temporary or permanent deployment
- Included w/ SG Corporate & Enterprise levels
- Utilizes existing hardware

## Anti-Passback

Anti-Passback refers to features in System Galaxy that prohibit/discourage cardholders from letting others use their credential (passing it back). Through the use of In and Out readers, Galaxy tracks the status of the cardholder and makes changes accordingly. This way a credential may only be used on an out reader if the user status is 'IN', and vice versa. This is required if Mustering or Who's-In reporting are being used.

## Overview

Utilizing standard SG features - Anti-Passback & Areas, current and future installations may be configured to not only provide access control, but directional control as well. Areas are defined by assigning readers into a group(s). Using readers grouped into an area will place a cardholder in or out of an area depending on configuration. With directional control, areas may be setup to accept only cardholders who have come from a specific area.

## For Instance...

### In/Out

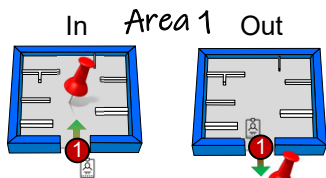

- 1 In Reader & Out Reader. Most basic form of anti-passback

### Nested

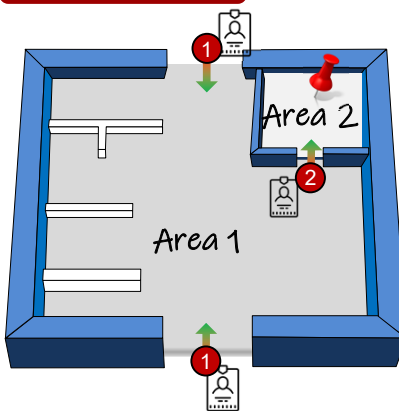

#### An Area in another Area

- 1 Entry from either reader will change user status from 'Unknown' to "IN" Area 1.
- 2 Entry into Area 2 requires being 'IN' Area 1. Entry using this reader does not change cardholder status - remaining as 'IN' Area 1, thus not requiring an exit or 'out' reader to get back 'IN' Area 1.
- 1 Number of areas: 254

### Directional

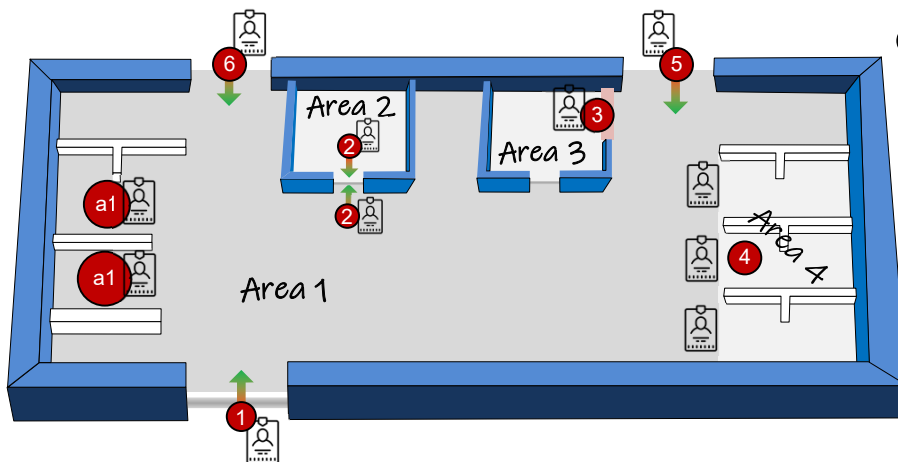

- 1 Cardholder status changes from 'Unknown' to 'IN' Area 1. All readers associated with Area 1 are accessible (a1). (a1) readers do not affect status.
- 2 Area 2 requires being 'IN' Area 1. Exiting Area 2 changes status back to 'IN' Area 1. Cardholders entering using readers 5 & 6 cannot access Areas 2 & 4 until they use reader 1.
- 3 'Check-in' reader changes user status to 'IN' Area 3. This allows access to Area 4 readers which are configured to accept cards only from Area 3.
- 4 Allows cards from Area 3 only.
- 5 & 6 Do not change user status. It will be 'Unknown'. This will prohibit entry into Area 2 and the use of readers (a1).

## Screening Enforcement

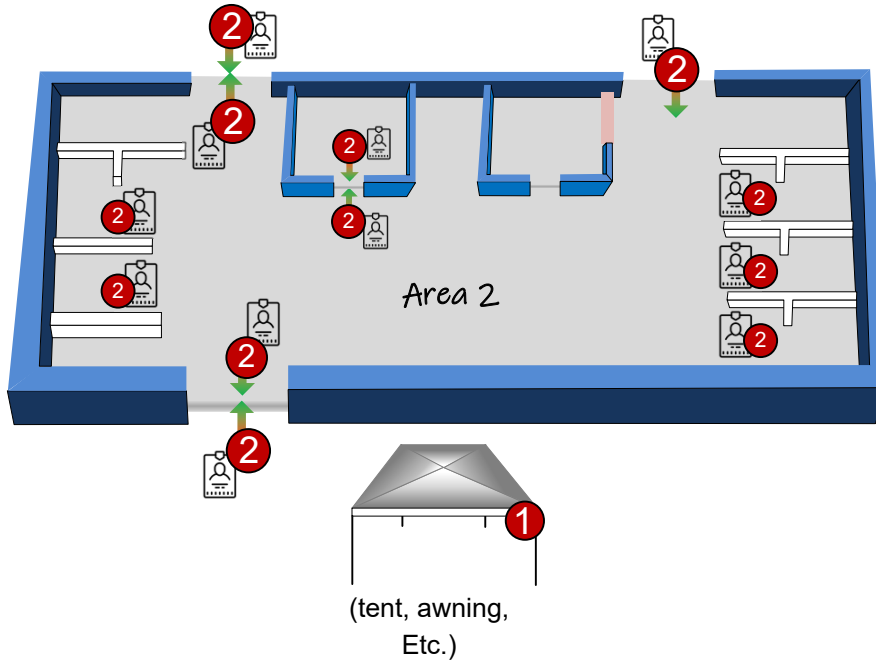

### A word on access privileges...

Access rules & privileges are in full effect as usual. Implementing anti-passback and areas will not change a cardholder's access group permissions. Only rules are being added.

Resetting cardholder status to 'Unknown' will not affect cardholders needing to exit the building.

- 1 A cardholder arrives at a temporary/permanent screening location physically/logically isolated from the main facility. After a successful screening, his or her credential is presented to a system reader. This will change cardholder status to 'IN' Area 1.

**OR**

The cardholder failed the screening. Notification is sent to the System Galaxy administrator to immediately disable all credentials and add notes to the person's record.

- 2 Area 2 requires passage from Area 1. Area 2 can have many readers. Only Area 2 exit readers will change the cardholder status. This prevents cardholders who did not process through Area 1 from gaining entry via ANY Area 2 reader.

- ! After successful processing at the screening Area 1, cardholders may enter and exit Area 2 as they please (lunch, breaks, etc.) w/o having to rescreen in Area 1.  
NOTE: Nested & Directional Areas perform normally in this scenario.

- ! At midnight (other times available) every cardholder status is set to 'Unknown,' rendering all cards unable to access any reader assigned to Area 2 until the screening process is completed again at the beginning of his/her shift. Resetting cardholder status to 'Unknown' will not affect cardholders ability to exit the building.

## Area 1 Reader Options

